



WHISPERLITE™ UNIVERSAL STOVE

MOUNTAIN SAFETY RESEARCH®



INSTRUCTION MANUAL

PUMP AND FUEL ADAPTER MAINTENANCE

O-rings can become dry, cracked, or torn with use. Their lifespan is affected by dirt, debris, temperature, friction and frequency of use. For this reason, please inspect your O-rings before every trip. Replace dry, cracked, or torn O-rings immediately, and replace all O-rings annually, regardless of appearance. Replacement O-rings and Pump Seals can be found in the Annual Maintenance Kit or the more comprehensive Expedition Service Kit, purchased separately from an MSR® dealer.

REPLACING FUEL TUBE O-RING

1. Remove Plunger.
 - Align, twist, and pull.
2. Remove Fuel Tube Bushing and O-Ring with Jet and Cable Tool.
 - Remove the O-ring with the end of the Liquid Fuel Adapter or Safety Pin.
3. Inspect O-ring and replace if damaged.
 - If needed, a spare and Fuel Tube O-ring is provided.
4. Lubricate Pump Cup, Use a drop of Pump Cup Oil or any mineral-based oil.
5. Insert Plunger.
 - Hold thumb and forefinger firmly around Arrow 1.
 - Align Plunger Bushing tabs with holes in Pump Body.
 - Push Plunger/Bushing into the Pump Body until it snaps in place.

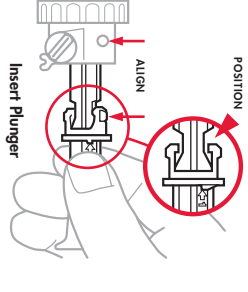
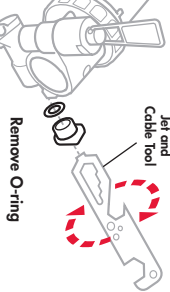
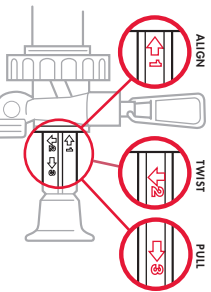

REPLACING CONTROL VALVE O-RING

1. Unscrew Stop Nut 2 turns.
2. Unscrew Control Valve & turn.
3. Unscrew Stop Nut completely and remove Control Valve Assembly.
4. Inspect O-ring and replace if damaged.
 - Remove Control Valve handle from stem.
 - Slide Stop Nut off.
 - Remove O-ring with Safety Pin.

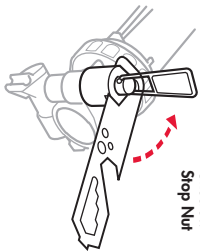

REPLACING PUMP SEAL

1. Inspect Pump Seal and replace if damaged.

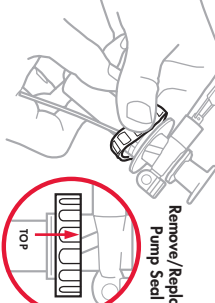

CLEANING THE CHECK VALVE

1. Turn Check Valve Assembly to remove.
2. Wipe any debris from Check Valve and Pump Convy.
3. Reinsert Check Valve Assembly.

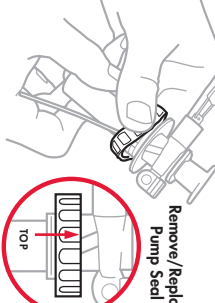

Remove Check Valve Assembly



WARNING

Improper installation, use, adjustment, alteration, service, or maintenance can cause injury or property damage. Refer to this manual. For assistance or additional information consult Cascade Designs.

Limited Warranty details at msrgear.com/warranty



Cascade Designs, Inc.
4000 First Avenue South, Seattle, WA 98134 USA
1-800-531-9531 or 206-505-9500
www.msrgear.com

FOR OUTDOOR USE ONLY

 0051 UK CA 0088	Nominal Heat Input Rate: 2.4 kW, 185 g/h
 UL C E188800	 ETL C E188800
Stove Orifice Size [PG]: 0.31 mm NOTE: Nominal Heat Input Rate varies depending on test procedures of the particular standards agency.	

⚠ DANGER

- Check that the seals between the stove and the gas canister are in place and in good condition before connecting the stove to the cylinder. Do not use if it has damaged gaskets or worn seals.
- Gas containers must be changed in a well ventilated location outside and away from any sources of ignition, such as naked flames, pilot lights, electric fires and away from other people.
- Listen and smell for leaking gas. Leaking gas is a serious hazard. LPG is invisible and odorless, and strong odorant additives can fade over time. Leaks are not always detectable by smell. Do not use this stove if it is leaking, damaged, or does not operate properly.
- Check that the stove and fuel canister connection is secure and tight. If the connection does not look or feel secure, or if you hear or smell leaking gas and cannot stop the flow of gas, do not use stove or fuel canister. Move it to a well-ventilated area away from any ignition source to locate and stop the leak. Use of a leaking stove can cause fire, burns, severe injury or death.
- Check for leaks using soapy water. Do not try to detect leaks using a flame.
- Never use IsoPro fuel containers larger than 8 ounces [227 grams].
- Keep stove and fuel away from other heat sources. If you expose the fuel to high heat, it will explode or leak and you can be killed or seriously burned.
- Follow all warnings on fuel canister and fuel bottle regarding use and storage. Canister can be checked for remaining fuel by assembling and attempting to light stove.
- Do not store or use gasoline or other liquids with flammable vapors in the vicinity of this or any other stove except in the case of fuel being used as instructed for liquid fuel mode.
- Do not disassemble stove beyond what is described in these instructions. DO NOT MODIFY THIS STOVE. Disassembly or modification of stove in any manner not consistent with these instructions voids warranty and can result in an unsafe situation where fire, burns, severe injury or death can occur.
- Do not use stove if parts are missing or broken, or with replacement parts not specific to your stove model. Use of stove with missing or broken parts, or with replacement parts not specific to your stove model, can result in an unsafe situation where fire, burns, severe injury or death can occur.
- In canister fuel mode, stove should not be operated or stored at temperatures below 0°F / - 18°C. In liquid fuel mode with MSR Arctic Fuel Pump, stove should not be operated or stored at temperatures below -40°F / - 40 °C.

STOVE MAINTENANCE

Deposits in the Jet and Fuel Line reduce fuel flow and impair stove performance. Minor deposits in the Jet can be cleared with the Shaker Needle. Major deposits may require more extensive cleaning of the Jet and Fuel Line. At a minimum, perform the following maintenance annually or every time you perform the Pump Maintenance.

CLEANING THE JET WITH THE SHAKER NEEDLE

1. Close Pump Control Valve and wait 5 minutes for stove to cool.
2. Slide stove up and down.
3. Push Shaker Needle inside Jet should rattle.
4. Reinstall Fuel Line into Fuel Adapter.



CLEANING THE JET AND FUEL LINE

1. Fold Jet Support/Legs to packed position.
2. Unscrew Priming Cup and remove Wick.
3. Hold folded Jet Support/Legs together.
4. Unscrew Jet with Jet and Cable Tool.

IMPOURANT: Do not bend Generator Tube while loosening Jet.

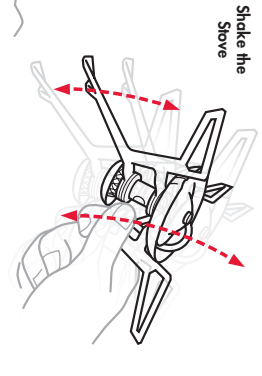

Unscrew Priming Cup

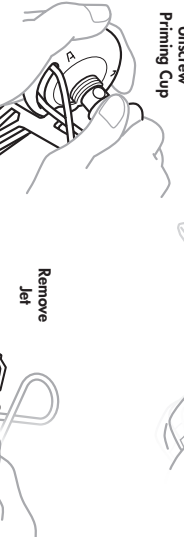

Remove Jet



⚠ DANGER

CARBON MONOXIDE, FIRE & EXPLOSION HAZARD

There are serious hazards associated with using this stove. This stove is a lightweight, compact device made for OUTDOOR USE ONLY to boil water or cook food. Never use it for any other purpose. Use of stove within any enclosure, or for a purpose other than boiling water or cooking food can cause fire, burns, severe injury or death. Cooking outdoors is more hazardous than cooking as you normally would at home. Please consult with your local outdoor retailer to learn more about cooking outdoors. Seek qualified instruction before you venture outdoors. This stove in canister fuel mode uses a liquid pressurized gas (LPG) container that is highly flammable and and explosive.

FUEL INFORMATION

The Whisperlite™ Universal stove can burn a variety of fuels by exchanging the Jet and Fuel Adapter.

1. The US Jet and Liquid Fuel Adapter are used for White Gas and Unleaded Auto Gas.
2. The UK Jet and Liquid Fuel Adapter are used for Kerosene.
3. The US Jet and Canister Fuel Adapter are used for canister fuels.

Both the UK and US Jet and the Liquid Fuel Adapter are included in the parts kit with your stove.

To exchange the Jet or Fuel Adapter, see Stove Preparation.

Use MSR® SuperFuel™ (White Gas) or MSR IsoPro (canister fuel) for optimal performance. It is the highest quality fuel available for your stove. Do not use other fuels. The use of other fuels may require more frequent Jet and Fuel Line cleanings. Also, the use of Unleaded Auto Gas may shorten stove lifespan. Use the fuels chart to help you find your fuel when traveling internationally. Use of stove with non-MSR fuel products is not recommended.

Visit www.msrgear.com for more information on international fuel names and safe stove transportation.

FOR YOUR SAFETY

Do not store or use gasoline or other liquids with flammable vapors in the vicinity of this or any other stove.

FIRE OR EXPLOSION HAZARD

If you smell gas: 1. Do not attempt to light appliance. 2. Make sure stove is in the off position. 3. Extinguish any nearby flame(s). 4. Disconnect fuel cylinder. 5. Leave the area immediately. 6. Allow gas to dissipate 5 minutes. 7. If gas smell has dissipated from the area of the appliance and fuel supply, follow gas connection procedures. 8. If you smell gas again, follow steps 1-9-1-9-1-9 and have appliance serviced. Failure to follow these instructions could result in fire or explosion, which could cause property damage, personal injury, or death.

FOR OUTDOOR USE ONLY / CARBON MONOXIDE HAZARD

⚠ DANGER

This stove can produce carbon monoxide, which is poisonous and has no odor. Using it in an enclosed space can kill you. Never use this stove in an enclosed space such as a camper, tent, or other home.



TROUBLESHOOTING

Problem	Cause	Solution
Leaking Fuel	At Pump and Fuel Bottle Connection Damaged or missing Pump Seal	Replace Pump Seal
At Pump and Fuel Line Connection Idle O-ring	Damaged or missing Fuel O-ring	Replace Fuel Tube O-ring
At Control Valve Stem Control Valve O-ring	Damaged or missing Control Valve O-ring	Replace Control Valve O-ring
In Pump Plunger Chamber Obstructed Check Valve	Clean Check Valve Convey	
Poor Performance (Canister Fuel)	Loose or poorly seated Pump on Fuel Bottle Damaged Pump Cup Replace Pump Cup	Tighten or rescrew Pump on Fuel Bottle Replace Pump Cup
Plunger hard to pump Dry Pump Cup	Lubricate Pump Cup	
Diminished flames Low Fuel Bottle pressure	Pump the Plunger	
Poor Performance (Canister Fuel)	Low fuel Cold canister Replace canister	Replace canister
Diminished flames Cold canister	Warm canister Use Wind Screen	Warm canister Use Wind Screen
Stove does not light Windy conditions Empty canister	Replace canister	Replace canister
Erratic yellow flames Improper packing	Repeat Step 3	
Stove boil times Clogged Jet or Fuel Line	Clean Jet and clean Fuel Line	
Diminished flames at altitude Insufficient airflow	Open Windscreen slightly	

*To check if canister is empty, remove stove and gently shake canister. If a splashing sound is heard, canister still contains fuel.

Low Performance (All Fuels)
Cause
Incorrect Jet/Fuel Adapter configuration.
Solution
Check Jet and Adapter - install in use configuration for fuel.

Erratic yellow flames
Cause
Improper packing
Solution
Repeat Step 3

Stove boil times
Cause
Clogged Jet or Fuel Line
Solution
Clean Jet and clean Fuel Line

Diminished flames at altitude
Cause
Insufficient airflow
Solution
Open Windscreen slightly

⚠ WARNING

Do not disassemble stove or pump beyond what is described in these instructions. Disassembly or modification of stove or pump in any manner not consistent with these instructions voids warranty and can result in an unsafe situation where fire, burns, severe injury or death can occur. Do not use stove or pump if parts are missing or broken, or with replacement parts not specific to your stove model. Use of stove with missing or broken parts, or with replacement parts not specific to your stove model, can result in an unsafe situation where fire, burns, severe injury or death can occur.

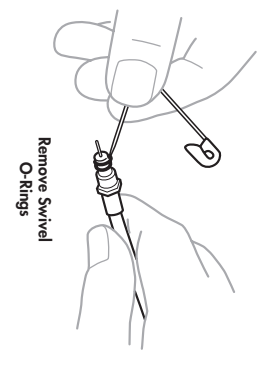

Remove Swivel O-Rings

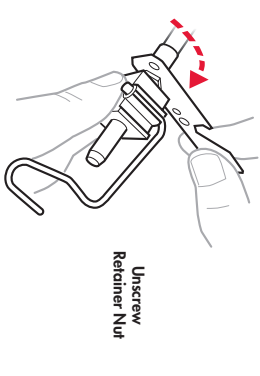
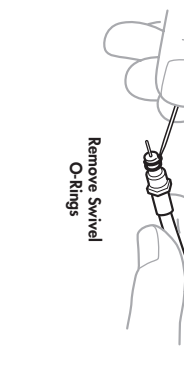

Unscrew Retainer Nut

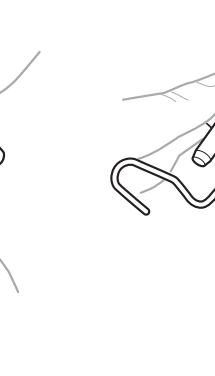

Remove Check Valve Assembly

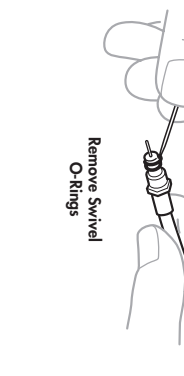

KNOW YOUR MSR® WHISPERLITE™ UNIVERSAL STOVE

Please familiarize yourself with the parts of your WhisperLite Universal stove and the following instructions before its use. Because this stove can accommodate different fuels, you may need to exchange the preinstalled UC Jet and the Canister Fuel Adapter before using this stove.

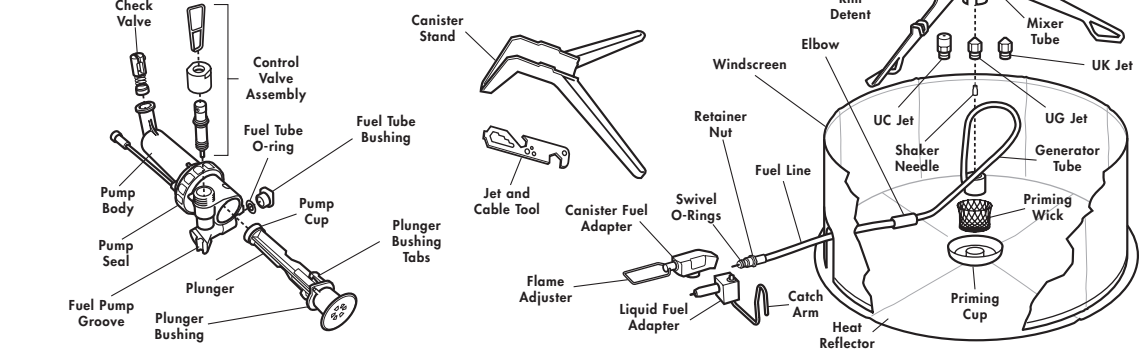

WARNING
Do not use this stove: (1) before reading and fully understanding this Instruction Manual; (2) if you are not prepared or comfortable attending to a burning and/or hot stove at all times; (3) if you observe leaking fuel; or (4) if you observe any condition with the stove system or in the surrounding environment that would make operation of an open flamed device dangerous. Failure to follow these directions can cause an unsafe situation leading to fire, burns, severe injury or death.

FUEL BOTTLE PREPARATION

Ensure that the WhisperLite™ Universal stove is configured with the correct Jet and Fuel Adapter. (See *Stove Preparation*.) If using a liquid fuel, prepare the Fuel Bottle before using the stove. If using a canister fuel, skip this panel and go now to **Step 1, Set Up Stove**.

PREPARING FUEL BOTTLE FOR LIQUID FUELS

1. Fill Fuel Bottle to fill line only.
Air space is necessary for fuel expansion.
2. Insert Pump into Fuel Bottle and firmly tighten.
3. Check Fuel Bottle for leaks before pressurizing the bottle.
4. Close the Control Valve, then stroke Plunger (20-30 strokes).
Pump until firm resistance is felt.
Less fuel requires more strokes or pressure.

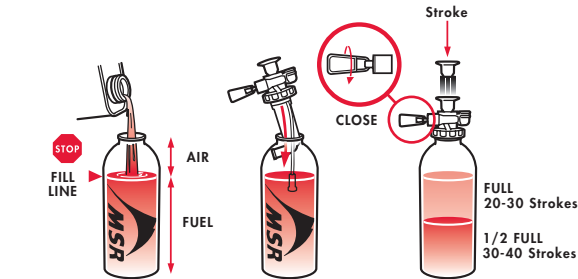

WARNING
Use MSR® fuel bottles only. Non-MSR fuel bottles may leak fuel creating an unsafe situation leading to fire, burns, severe injury or death. Keep children far away from stove and fuel—Cascade Designs, Inc. recommends no less than 10 feet (3+ meters). Never leave a burning or hot stove unattended. An unattended stove can lead to fire and/or a situation where children, pets, or the unwary can be burned, injured, or killed. Use extreme caution when using stove in temperatures below freezing. In freezing temperatures O-rings can stiffen and leak fuel. Always check for fuel leaks before and after pressurizing bottle, priming, and during and after lighting stove. Use of a leaking stove can cause fire, burns, severe injury or death.



CONNECT STOVE

Use UG Jet and Liquid Fuel Adapter for white gas and unleaded auto gas.
Use UK Jet and Liquid Fuel Adapter for kerosene. (See *Stove Preparation*.)

1. Lubricate the entire brass end of Liquid Fuel Adapter with saliva or oil.
2. Completely insert brass end of Liquid Fuel Adapter into Pump.
Place Fuel Line on its side so Control Valve points up.
3. Secure Catch Arm on Fuel Pump Groove.
Keep Fuel Line straight for safety.
Keep Fuel Bottle as far away from stove as possible.

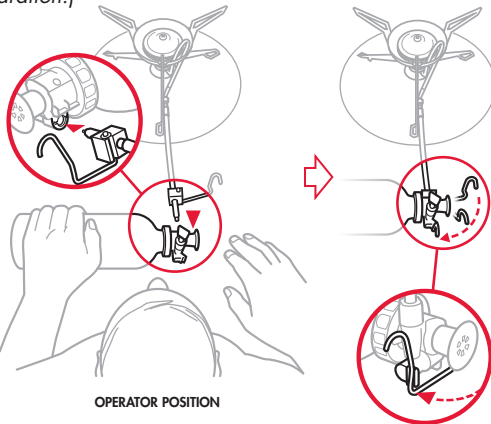

WARNING
Before every use, look for fuel on the fuel bottle, pump, fuel line, burner, and on the area beneath and around stove. Do not light stove if you see or smell fuel. (See *Troubleshooting*.) Use of stove where fuel has leaked or is leaking can cause fuel to ignite causing fire, burns, severe injury or death. Never disconnect the fuel line, pump, or fuel bottle when stove is burning, hot, or near any open flame. Disconnect fuel line, pump, or fuel bottle when control valve is in an open (i.e., fuel flowing) position. Disconnecting fuel line, pump, or fuel bottle when control valve is in an open (i.e., fuel flowing) position can lead to spilled fuel that can ignite and cause fire, burns, severe injury or death.



TURN STOVE ON

1. Release only ½ spoonful of fuel.
Open Control Valve (3/4 turn) and let fuel flow through the Jet.
Close Control Valve.
Look for fuel in Priming Cup and on Wick.
2. Light fuel in Priming Cup.
A brief soccer ball-sized flame is normal.
3. Wait for preheat flame to reduce in size (approximately 2 minutes).
If flame goes out, wait 5 minutes for stove to cool before relighting.
4. Open Control Valve (1/2 turn) and wait for steady blue flame.
5. Slowly open Control Valve.

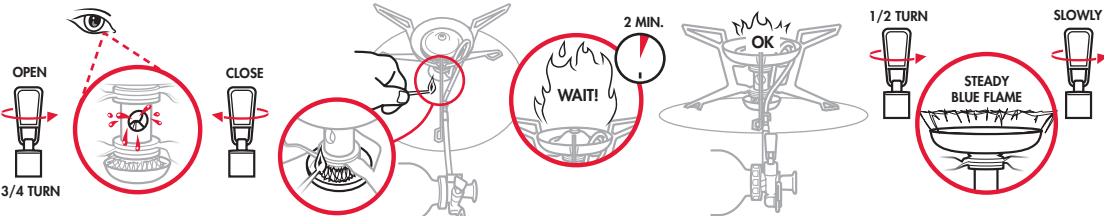

WARNING
Never place your head or body above the stove while priming, lighting, or cooking. Because stove maintains an open flame, placement of head or body above stove is an unsafe practice that can cause fire, burns, severe injury or death. Never use excess fuel to preheat stove. Use of excess fuel for priming can lead to leaking or spilled fuel that can cause fire, burns, severe injury or death. Never relight a heated stove. Always let an extinguished stove cool for at least 5 minutes before relighting. Relighting a heated stove can cause large flames that can cause fire, burns, severe injury or death. Never move a burning or hot stove. Always extinguish stove and cool for at least 5 minutes before moving. Moving a burning or hot stove can cause fire, burns, severe injury or death.



USE STOVE TO COOK

1. Set up Windscreen.
Fold the ends of Windscreen together.
Leave a 1-inch (2.5-cm) gap between Windscreen and pot for optimal performance.
Ensure that combustion flow and ventilation air are free of any obstruction.
Use Windscreen to improve performance in all conditions.
2. Add appropriate food or liquid to cookware.
3. Place cookware onto center of stove.
4. Maintain Fuel Bottle pressure.
Add approximately 10 strokes every 10 minutes to maintain performance.
Hold Fuel Bottle firmly while pumping.

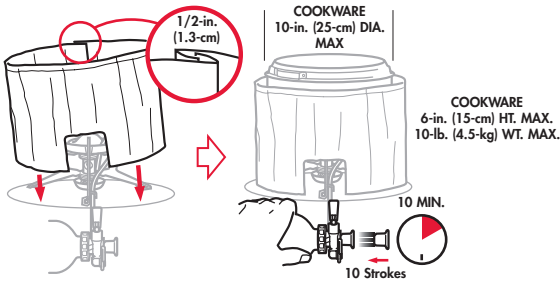

WARNING
Keep fuel bottle away from the stove burner and other heat sources. Position connected fuel bottle so that it is as far away from the burner as possible. Use of bottle near burner or other heat sources can result in the fuel bottle exploding and causing fire, burns, severe injury or death. Never place Windscreen around fuel bottle. Never use cookware with a diameter greater than 10 inches (25 centimeters). Never place and operate two or more stoves together. Never operate stove with empty or dry cookware. Never use non-MSR® reflectors or diffusers. Use of stove in any of the preceding manners can result in the fuel bottle exploding and causing fire, burns, severe injury or death. Never use cookware of any size that is ill-suited or inappropriate for use with stove or stove pot supports (e.g., cookware with a convex or concave bottom, some enameled cookware, etc.). Use of stove with ill-suited and/or inappropriate cookware can result in cookware and/or stove instability and a situation where hot cookware and/or cookware contents can spill and cause fire, burns, severe injury or death. Cascade Designs, Inc. warrants the use of appropriately sized MSR® brand cookware only—use of cookware other than MSR® brand cookware will be at user's own risk and discretion.



TURN STOVE OFF

1. Close the Control Valve.
Residual flame will continue to burn with a small flame.
2. After flames are out, wait 5 minutes for stove to cool.
3. Unlock Catch Arm and remove Fuel Line from Pump.
4. Depressurize Fuel Bottle and repack stove.
Hold Fuel Bottle upright, away from your face and any sources of heat or ignition.
Slowly unscrew pump to depressurize Fuel Bottle.

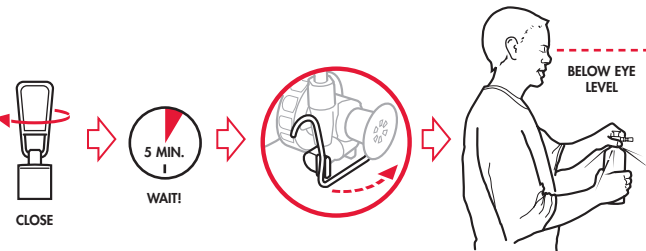

NOTICE: To transport the Fuel Bottle, the Pump may be left inside a depressurized Fuel Bottle. The Pump can also be removed and replaced with the Fuel Bottle Cap.

WARNING
Always store fuel bottle with cap securely tightened where it cannot be accessed by children. Storage of fuel bottle with loose cap and easy accessibility by children can result in a child opening the fuel bottle and accessing bottle contents. Exposure to or ingestion of bottle contents can cause poisoning, severe injury, or death. Always store fuel bottle in a well-ventilated location away from any possible heat or ignition source, such as water heaters, stoves, pilot lights, or furnaces. Storing bottle near any heat or ignition source can result in the fuel bottle exploding and causing fire, burns, severe injury or death.

STOVE PREPARATION

The WhisperLite™ Universal stove can be easily configured to burn white gas and unleaded gas, kerosene, and canister fuels. Before stove use, select the fuel and install the appropriate Jet and Fuel Adapter. (See *Fuel Information*.)

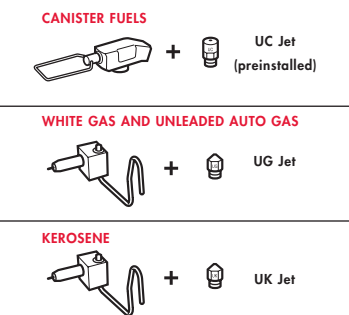

CONFIGURING STOVE FOR DIFFERENT FUELS

CHANGING THE JET

1. Fold Pot Supports/Legs.
 2. Unscrew Priming Cup and remove Wick.
 3. Remove Fuel Line from stove.
 4. Loosen current Jet with Jet and Cable Tool.
Carefully unscrew Jet to avoid losing Shaker Needle inside the Elbow.
- IMPORTANT: Do not bend Generator Tube while removing Jet.
5. Set new Jet carefully over the Shaker Needle and screw into place.
Gently tighten the Jet with Jet and Cable Tool.
 6. Hold folded Pot Supports/Legs together and reinstall Fuel Line.
Replace Wick and rescrew Priming Cup to reassemble stove.

CHANGING THE FUEL ADAPTER

1. Loosen Retainer Nut on current Fuel Adapter with Jet and Cable Tool.
2. Unthread Retainer Nut and disconnect Fuel Adapter from Fuel Line.
3. Insert end of Fuel Line into new Fuel Adapter.
4. Gently tighten Retainer Nut with Jet and Cable Tool.

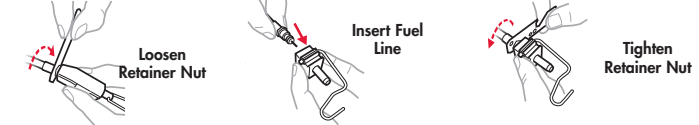

1 SET UP STOVE

1. Close Control Valve/Flame Adjuster Valve.
Rotate Pot Supports/Legs fully open.
3. Place stove on the center of the Heat Reflector.

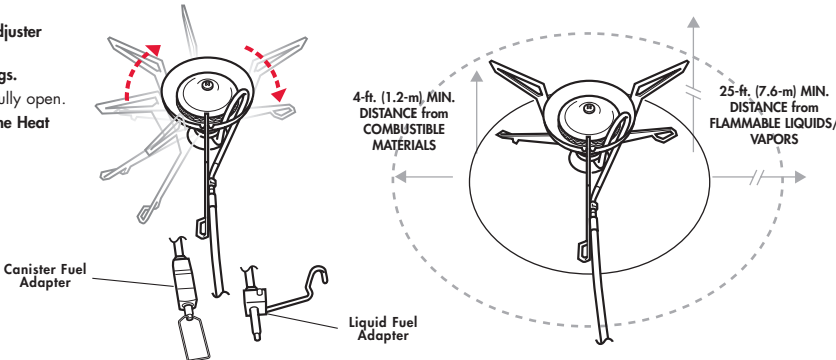

WARNING
Keep combustibles at least 4 feet (1.2 meters) away from the top and sides of a burning stove or a stove that you are in the process of lighting. Keep flammable liquids and vapors at least 25 feet (7.6 meters) away from the top and sides of a burning stove or a stove that you are in the process of lighting. This stove can ignite combustible materials, flammable liquids and vapors creating a situation where fire, burns, severe injury or death can result. This stove is designed for the outside (i.e., not within enclosure spaces of any kind, e.g., tents) and for the boiling of water or cooking of food only—never use it for any other purpose. Use of stove within any enclosure or for a purpose other than boiling water or cooking food can cause fire, burns, severe injury or death.



CONNECT STOVE

Use UC Jet and Canister Fuel Adapter for all canister fuels. (See *Stove Preparation*.)

1. Unfold Flame Adjuster.
2. Close Flame Adjuster Valve on Canister Fuel Adapter.
3. Screw Fuel Canister onto Canister Fuel Adapter.

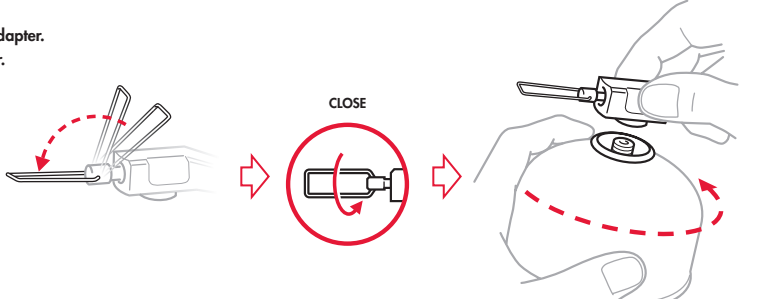

WARNING
Never overtighten fuel canister to stove. Overtightening can damage stove or canister and cause fuel to leak. Leaking fuel can cause fire, burns, severe injury or death. Use extreme caution when using stove in temperatures below freezing. In freezing temperatures O-rings can stiffen and leak fuel. Always check for fuel leaks before and after lighting stove. Use of a leaking stove can cause fire, burns, severe injury or death. Keep children far away from stove and fuel—Cascade Designs, Inc. recommends no less than 10 feet (3+ meters). Never leave a burning or hot stove unattended. An unattended stove can lead to fire or a situation where children, pets, or the unwary can be burned, injured, or killed.



TURN STOVE ON

IMPORTANT: ALWAYS START STOVE WITH FUEL CANISTER IN UPRIGHT POSITION TO PREVENT A LARGE FLARE-UP.

VAPOR FEED MODE (most conditions, best simmering)

1. Hold a lit match or lighter over the edge of Burner Head.
2. Open Flame Adjuster Valve (3/4 turn) to release and ignite fuel.
3. Turn Flame Adjuster Valve to produce and maintain steady blue flame.

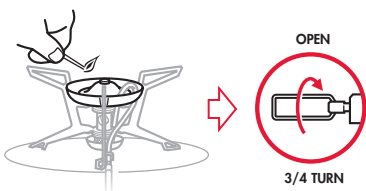

LIQUID FEED MODE (very cold conditions or higher output/faster boiling)

1. Attach Canister Stand onto top of Canister Fuel Adapter.
2. Hold a lit match or lighter over the edge of the Burner Head.
3. Open Flame Adjuster Valve (3/4 turn) to release and ignite fuel.
Allow fuel to burn for 30 seconds to sufficiently preheat stove.
4. Invert Fuel Canister, using Canister Stand to support it.
5. Turn Flame Adjuster Valve to produce and maintain steady blue flame.

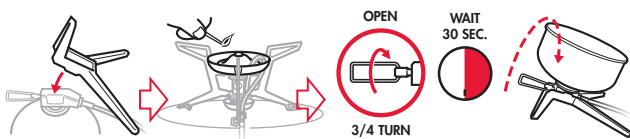

WARNING
Never place your head or body above the stove while priming, lighting, or cooking. Because stove maintains an open flame, placement of head or body above stove is an unsafe practice that can cause fire, burns, severe injury or death. Never relight a heated stove. Always let an extinguished stove cool for at least 5 minutes before relighting. Relighting a heated stove can produce large flames that can cause fire, burns, severe injury or death. Never move a burning or hot stove. Always extinguish stove and cool for at least 5 minutes before moving. Moving a burning or hot stove can cause fire, burns, severe injury or death. Never attempt to light stove if Flame Adjuster Valve is left open. If Flame Adjuster Valve is left open, close it immediately and thoroughly ventilate area before lighting stove. Failure to ventilate area can result in an explosion that can cause fire, burns, severe injury or death.



USE STOVE TO COOK

1. Set up Windscreen.
Fold the ends of Windscreen together.
Leave a 1-inch (2.5-cm) gap between Windscreen and pot for optimal performance.
Ensure that combustion flow and ventilation air are free of any obstruction.
Use Windscreen to improve performance in all conditions.
2. Add appropriate food or liquid to cookware.
3. Place cookware onto the center of stove.

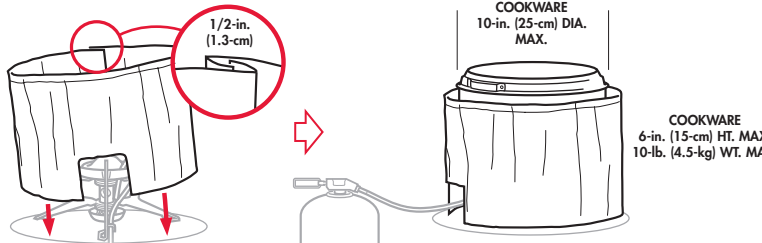

WARNING
Never use cookware with a diameter greater than 10 inches (25 centimeters). Never place and operate two or more stoves together. Never operate stove with empty or dry cookware. Never use non-MSR® reflectors or diffusers. Use of stove in any of the preceding manners can result in the fuel canister exploding and causing fire, burns, severe injury or death. Never use cookware of any size that is ill-suited or inappropriate for use with stove or stove pot supports (e.g., cookware with a convex or concave bottom, some enameled cookware, etc.). Use of stove with ill-suited and/or inappropriate cookware can result in cookware and/or stove instability and a situation where hot cookware and/or cookware contents can spill and cause fire, burns, severe injury or death. Cascade Designs, Inc. warrants the use of appropriately sized MSR® brand cookware only—use of cookware other than MSR® brand cookware will be at user's own risk and discretion.



TURN STOVE OFF

1. Place the Fuel Canister in the upright position if inverted.
2. Close the Flame Adjuster Valve.
Residual flame will continue to burn with a small flame.
3. After flames are out, wait 5 minutes for stove to cool.
Remove Canister Stand if attached.
Fold Flame Adjuster Valve.
4. Ensure that burners are extinguished.
Fold Pot Supports/Legs.
5. Move stove assembly away from any ignition sources and unscrew Fuel Canister.
A small amount of gas may escape when unscrewing canister.

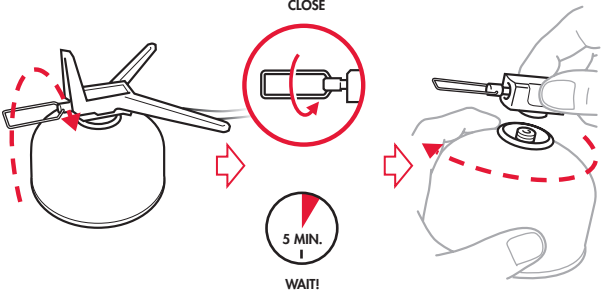

If canister is completely empty of fuel, follow proper disposal requirements in your local area.

WARNING
Always disconnect stove from canister before storing it. Failure to disconnect stove from canister before storing may allow fuel to leak and cause fire, burns, severe injury or death. Always store fuel canisters in a well-ventilated location away from any possible heat or ignition source, such as water heaters, stoves, pilot lights, or furnaces, or where temperatures exceed 120 F (49 C). Storing fuel canisters near any heat or ignition source or where temperatures exceed 120 F (49 C) can result in the canister exploding and causing fire, burns, severe injury or death.